

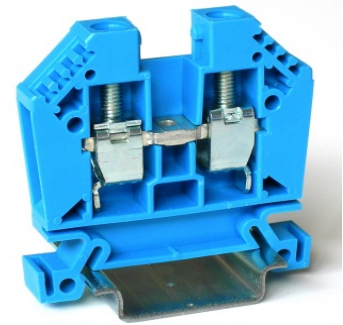

# EURO 10

Article: **43402 BL**

Feed-through terminal block - Blue  
Screw connection - 10mm<sup>2</sup> / 6AWG - Width 9 mm



## GENERAL DATA

Series	<b>EURO 10</b>
Item	<b>43402 BL</b>
Weight/Piece	<b>18,8 g</b>
Catalog	<b>01</b>
Customs tariff	<b>85369095</b>
Colour	<b>Blue</b>
Q.ty p.pck.	<b>50</b>
Q.ty p. box	<b>1000</b>

## TECHNICAL DATA / DIMENSIONS

### Dimensions

Width mm	9
Length mm	50
Height mm	44
Mounting type (EN 60715)	Omega TH35

### Technical data

Maximum load current	65A
Insulating material	PA
Self-extinguishing degree acc. to UL94	V0
Rated surge voltage	8kV
Pollution degree	3
Surge voltage category	III
Insulating material group	I
Nominal Voltage	1000V
Nominal Current	57A
Temperature index, insulating material – Elec. UL 746 B - RTI	130°C
Static insulating material lower permissible temperature	-60°C

### Connection data

Conductor cross-section solid min/max	1.50 / 16 mm <sup>2</sup>
Conductor cross-section stranded min/max	1.50 / 10 mm <sup>2</sup>



AWG min/max	20-6AWG
Max conductor cross-section stranded with ferrule with plastic sleeve DIN 46228/4	10 mm <sup>2</sup> / L=18 mm
Stripping length	max 12 mm
Screw	M4 – Zinc plated steel
Tightening torque	1.2Nm / 20 Lb-In
Clamp	Zinc plated steel
Current bar	Tin Plated copper alloy

## APPROVALS



40016498

REG B573

**EN60947-7-1**10mm<sup>2</sup> – 1000V – 57A**EN60068-2-11**

Salt mist test for 96 hours

**ENEL DV27****UL1059**

E203985

*Not suitable for Compact Stranded*

AWG 20-6 – 600V – 65A

**SCCR** 100kASee: <https://iq.ulprospector.com/en/profile?e=167250>

## TECHNICAL DRAWINGS

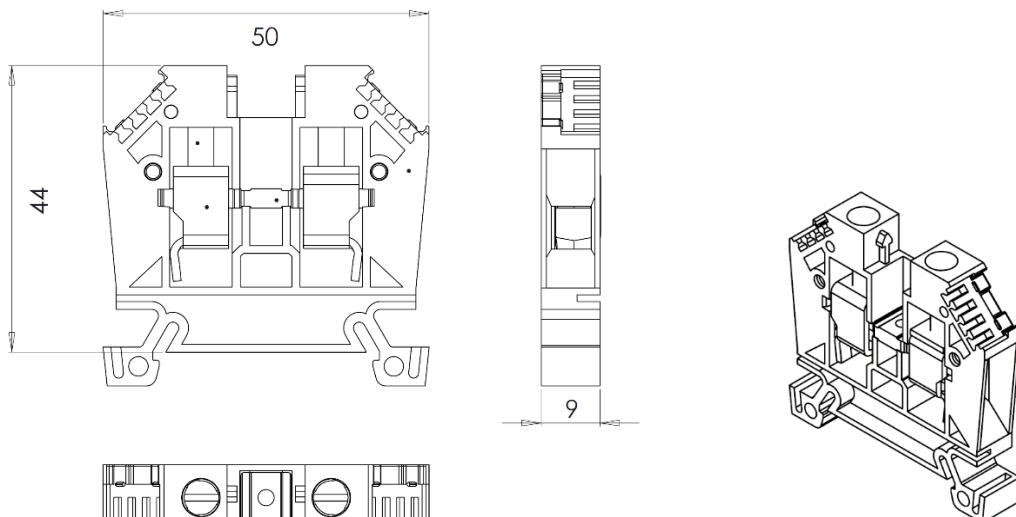



## ACCESSORIES

### Marking

Item	Description
<b>43059</b>	Single-digit marking tag (5 x 3 mm) - white
<b>43060/0 ÷ 43060/9</b>	Single-digit marking tag (5 x 3 mm) – with marking: 0 ÷ 9
<b>43060/A ÷ 43060/Z</b>	Single-digit marking tag (5 x 3 mm) – with marking: A ÷ Z
<b>43094</b>	Marking tag adapter – 6 slots for marking tags
<b>43192</b>	Marking tags (5 x 12 mm) - white (special marking on request)
<b>43196</b>	Marking tags (6 x 12 mm) - white (special marking on request)
<b>438MFC0612TB</b>	Tags 6x12 for MI and 438MWK0512TBA (39tags x 20cards)

### DIN RAIL system - Mounting and Installation material

Item	Description
<b>43910</b>	Steel Omega rail 35/7,5mm - 2mt length
<b>43910/F</b>	Slotted steel Omega rail 35/7,5mm - 2mt length
<b>43911</b>	Steel Omega rail 35/15mm - 2mt length
<b>43911/F</b>	Slotted steel Omega rail 35/15mm - 2mt length
<b>43028</b>	Angled support bracket
<b>43442</b>	EURO STOP - End bracket width 9
<b>43444</b>	EURO STOP - End bracket width 6
<b>43447</b>	EURO STOP - Snap-on end bracket width 6
<b>43448</b>	EURO STOP – Tag Carrier for TH35 or TH15 DinRail
<b>43449</b>	EURO STOP - End bracket cover profile carrier
<b>43449-C</b>	EURO STOP - Cover profile - Length 100cm

### Additional items

Item	Description
<b>43011</b>	End plate
<b>43016</b>	Separator
<b>43031</b>	Cover for EURO 6 - 10
<b>43022/02S</b>	Jumper bar (2 poles+200screws 43042) for EURO 10, 100pcs
<b>43022/03S</b>	Jumper bar (3 poles+300screw 43042s) for EURO 10, 100pcs
<b>43022/04S</b>	Jumper bar (4 poles+400screws 43042) for EURO 10, 100pcs
<b>43022/0.5MS</b>	Jumper bar (0,5m+55screws 43042) for EURO 10